

# Mainit Illusion

By Saluhan Collective x Liquid Architecture

## Access Guide



**Image:** A landscape photograph of the front of a house and its tropical garden. Attached to the house in the right-hand corner is a shop with a corrugated roof. A large tree towers over the shop front. The photograph is highly-saturated in the colours of purple, yellow, and green with a grainy texture. The words 'Mainit Illusion' written in large red block print are overlaid on the image, there are small yellow lines running through each letter.

### Updates to this document

Please note, this exhibition is a new work and changes are being made by artists until opening. We will endeavour to provide the latest access information across key stages of installation and presentation.

This document was created: 14 February 2024

Revision 1: 20 February 2024

# Contents

Where .....	3
When .....	3
About the exhibition .....	5
Entry to space .....	11
Shocks or surprises .....	12
Audience experience .....	12
Social expectations .....	12
Other.....	13
Content Warnings.....	13
The Venue .....	14
Front Entrance .....	14
Accessible Entrances .....	15
Reception .....	16
Quiet Space .....	16
Bathrooms.....	17
Lift .....	18
Transport .....	18
Tram.....	18
Train.....	19
Bus.....	19
Parking.....	19
COVID Safety .....	19

## **Where**

Arts House  
521 Queensberry Street  
North Melbourne VIC

## **When**

Monday 19 February to Saturday 23 March 2024  
Mon – Fri, 10.30am – 4.30pm  
Sat, 11am – 4pm  
Closed Sun and Public Holidays

## **Access Services**



Assistance Animal are welcome.



Open captioning – all video works with dialogue have English captioning.



Visual Rating 50% – contains both sound and visual components, but hearing is not essential to be able to engage with the exhibition.



Aural Rating 50% – contains both sound and visual components, but sight is not essential to be able to engage with the exhibition.



This exhibition is fully accessible for wheelchair users.



Quiet Space – located on Ground Level near reception, this is a shared space suitable for recovery from sensory overload, prayer, or parenting. It features a range of seating options, dimmable lights, sensory and stimming objects. Anyone is welcome to access this space during venue operating hours and events.

## About the exhibition

Mainit Illusion is a multidisciplinary exhibition that takes place over multiple locations inside Arts House. There is a total of 7 artworks across the foyer, staircase, halls, terrace, and lift. The exhibition can be viewed as a loop or in any order. You are welcome to engage with the exhibition at your own pace.

The artists exhibiting works are Catherine Ortega-Sandow, MJ Flamiano, Kenneth Suico, Del Lumanta, Mariam Ella Arcilla (Magenta House), Neil Cabatingan (Kuya Neil), Ranima Montes, and Raquel Solier (Various Asses).

## Artworks

### ***boybarbie subpoenaed in a manila envelope***

By MJ Flamiano

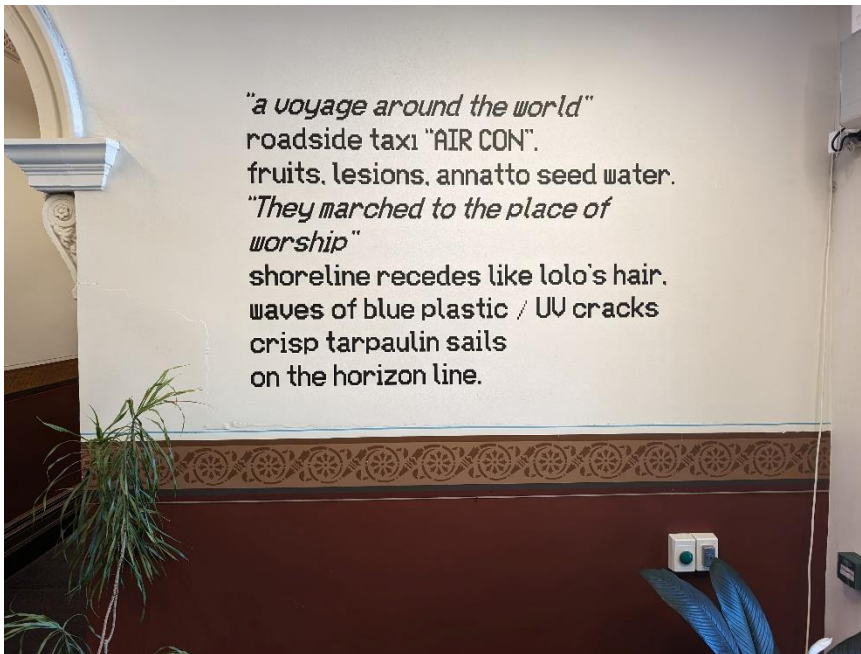

**Image:** A photograph of one of the five text excerpts printed on the wall from “boybarbie subpoenaed in a manila envelope”. It is written in a black, pixelated font. This excerpt reads, “*“a voyage around the world”* roadside taxi “AIR CON”. fruits, lesions, annatto seed water. *“They marched to the place of worship”* shoreline recedes like lolo’s hair, waves of blue plastic / UV cracks crisp tarpaulin sails on the horizon line.”

- **Location:** This series of works is located in the foyer, staircase and level one hallway.
- **Sound:** There is no sound in this work.

- **Lighting:** The building will have dimmed interior lighting in the foyer and staircase. The hallway will have standard interior lighting and natural light filtered through the windows.
- **Physical:** The venue has air conditioning. Rooms are temperate.
- **Smell:** There are no scents or smells in this work.
- **Visual:** This work consists of a series of five text blocks printed on multiple walls across the building including the foyer, staircase, hallway, and lift doors.

## Holy Ghost

By Ranima Montes

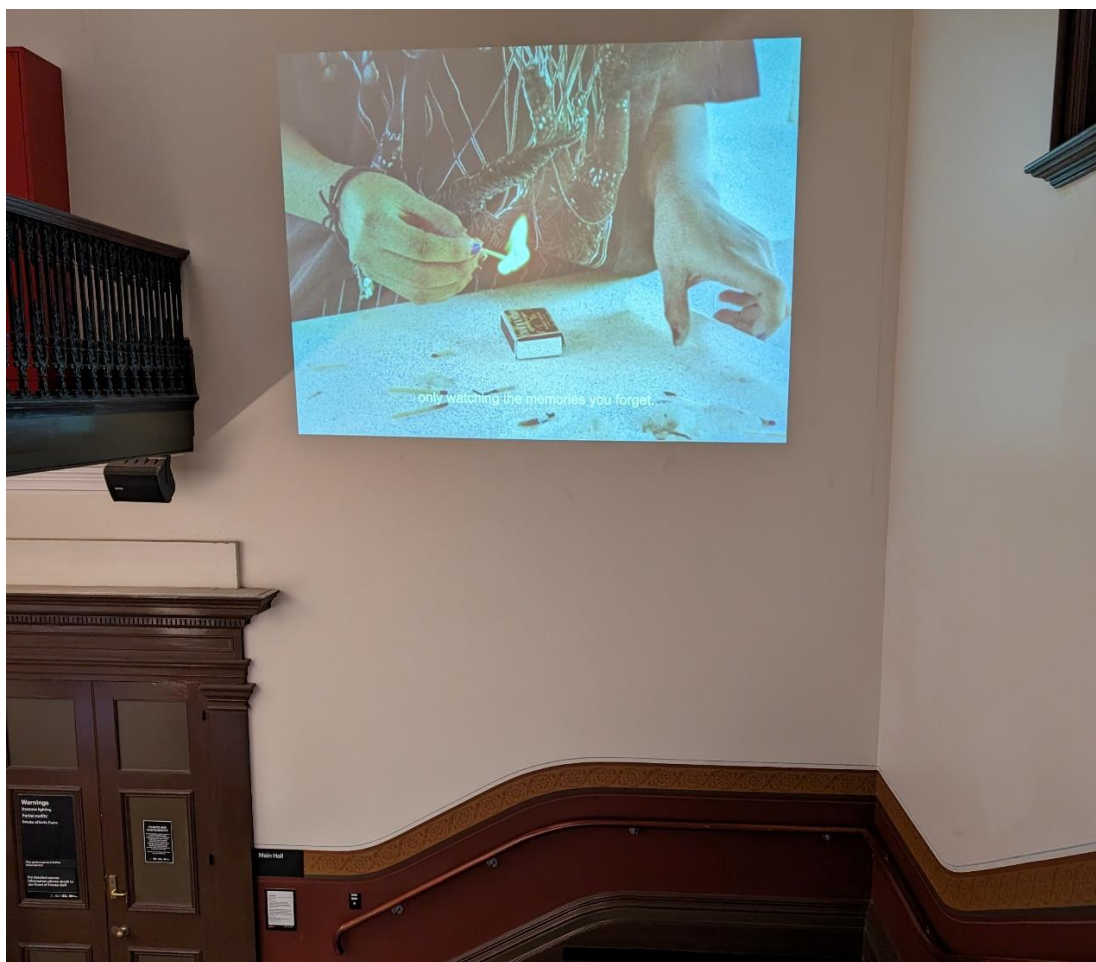

- **Location:** This work is located on the staircase.
- **Sound:** This film features some music and dialogue. It can be accessed via a headset available at the reception desk.
- **Lighting:** The staircase will have dimmed interior lighting.
- **Physical:** The venue has air conditioning. Rooms are temperate.
- **Smell:** There are no scents or smells in this work.

- **Visual:** This film is projected on to a wall and can be viewed from the foyer, staircase or first floor landing. The work is in Tagalog with English subtitles.

## **Matalik**

By Raquel Solier, Neil Cabatingan, Del Lumanta



- **Location:** This work is in the lift.
- **Sound:** The sound fills the lift. It is at a comfortable volume and plays on a loop.
- **Lighting:** The lift is bathed in a soft red light.
- **Physical:** The venue has air conditioning. Rooms are temperate.
- **Smell:** There are no scents or smells in this work.
- **Visual:** There are no visual elements in this work.

## Dodong and the Dais

By Catherine Ortega-Sandow, Kenneth L. Suico, MJ Flamiano

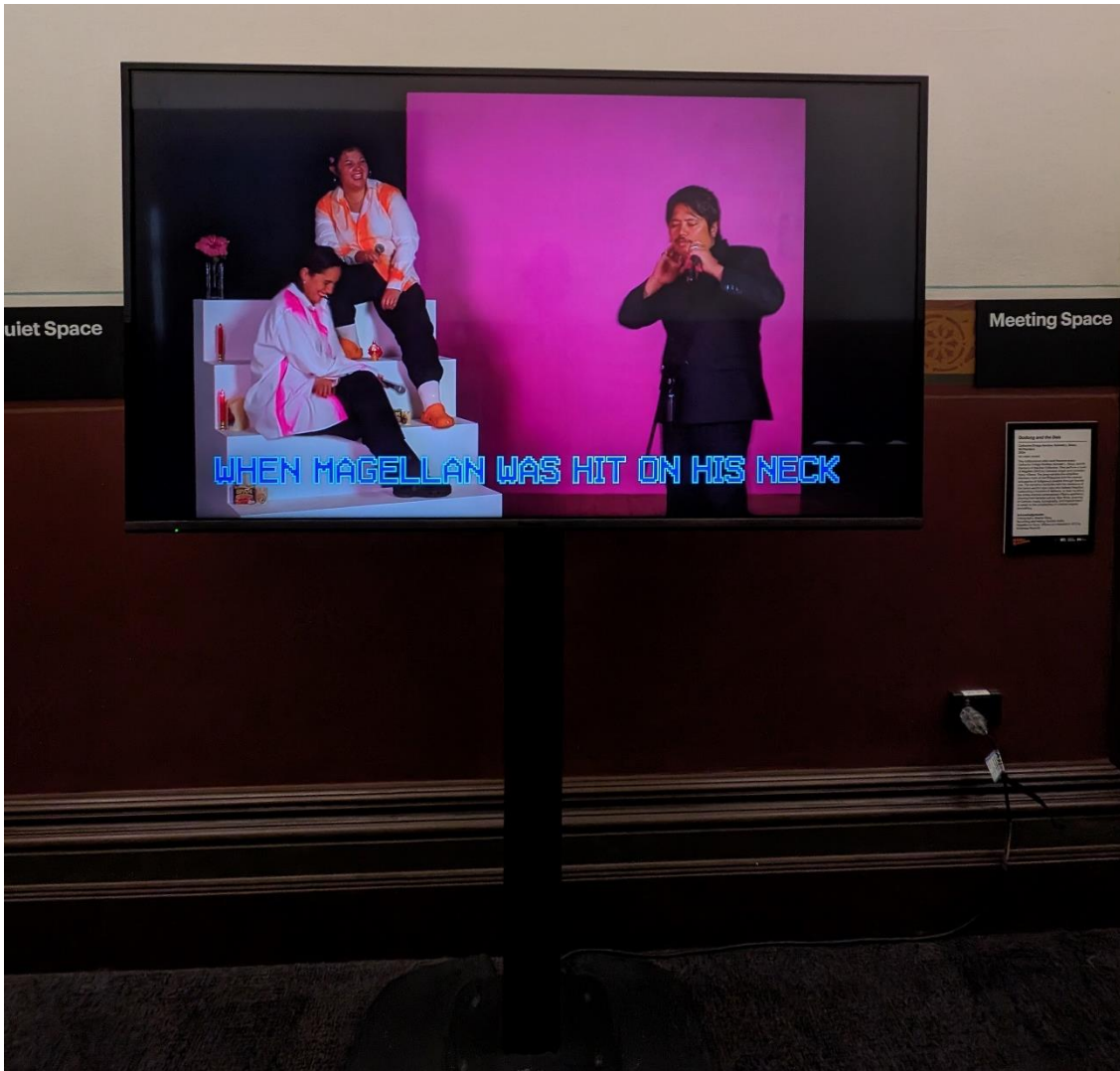

- **Location:** This work is in the hallway in the foyer next to the quiet space.
- **Sound:** Audio plays directly from the speakers and no headphones are required.
- **Lighting:** The hallway will have dimmed interior lighting.
- **Physical:** The venue has air conditioning. Rooms are temperate.
- **Smell:** There are no scents or smells in this work.
- **Visual:** This video work is viewed on a screen placed in a hallway. Subtitles appear on the screen similar to karaoke lyrics.



# A mango is shaped like a heart, but its own heart is a stone

By Mariam Ella Arcilla



- **Location:** This work is in the foyer outside the Main Hall.
- **Sound:** Audio for this work is accessible via headphones placed on top of the TV.
- **Lighting:** The building will have dimmed interior lighting.
- **Physical:** The venue has air conditioning. Rooms are temperate. A bench is placed in front of the TV. Audiences are encouraged to take a seat.
- **Smell:** There are no scents or smells in this work.
- **Visual:** This work plays on an old-fashioned TV placed in the foyer.

## Fate, 3 x a lady (puhonx2 dong)

By Kenneth L. Suico



- **Location:** This work is in the terrace on level one.
- **Sound:** Audio from this work plays through a speaker. No headphones are required.
- **Lighting:** This work is in natural light.
- **Physical:** This work is outdoors.
- **Smell:** There are no scents or smells in this work.
- **Visual:** A pink-blue clam is standing on a mirrored plinth with a speaker placed inside.

## Squeeze me like one of your Pink Lady's

By Catherine Ortega-Sandow



- **Location:** This work is at the terrace entrance on level one.
- **Sound:** There is no sound in this work.
- **Lighting:** This work is placed in front of large windows. Natural light fills the space.
- **Physical:** The venue has air conditioning. Rooms are temperate.
- **Smell:** There are no scents or smells in this work.
- **Visual:** This work features a series of five sculptures placed on the window ledges.

## Audience Experience

### Entry to space

The artworks in this exhibition are in multiple spaces of the Arts House building, including the ground floor and first floor.

## Access to the foyer:

- There are three different entry points to the main building. Two of these are wheelchair accessible entrances.
- The **Queensberry St** entrance has 9 steps with grab rails on both sides for all steps except the bottom two. The door for this entrance is a double glass door that opens automatically.
- The **Errol St** entrance is to the left of the Post Office. This entrance has an automatic door which is 850mm wide and operated by a push button to the right. This door will remain in its open position for approximately 20 seconds. This entrance can be accessed either via a ramp to the right of the Post Office entrance, or via three steps. The steps have tactile surface indicators and grab rails on either side. The button to open the automatic door is on the wall directly in front of the steps, and the automatic door will open to the left of this button.
- George Johnson Lane is located to the right of the Main Building. As this entrance is sometimes obstructed, we recommend using the Errol St entrance.

## Access to Level 1:

- Level 1 can be accessed either via lift or stairs from the foyer area.
- The stairs to Level 1 have grab rails on either side. Please note - this staircase is very wide, so grab rails are not able to be used on both sides at the same time.

Doors open to this event at the same time as a performance in the Main Hall concludes. There will be some overlap of audiences that will be managed if needed by front of house staff.

## **Shocks or surprises**

There are no shocks or surprises.

## **Audience experience**

There is no expectation for audiences and can experience the exhibition at any distance and pace that is comfortable.

## **Social expectations**

The audience will be able to move freely around the space. There might be staff, artists or other visitors to the building, but there is no requirement to interact with them. Our

friendly reception staff will be able to guide you to information about the exhibition or assist with any technical questions.

There are chairs available in the foyer and level 1.

## **Other**

### **Content Warnings**

- Themes of colonisation

## The Venue



Image: North Melbourne Town Hall features giant red letters that say ARTS HOUSE out the front of it.



Image: a map of Arts House and its surrounding area. [LINK TO MAP](#)

## Front Entrance



## Accessible Entrances



There are two Accessible Entrances. The first is on Errol St next to the Post Office.



Image: Errol Street entrance next to the Post office with wheelchair accessible ramp or two steps with grab rails.



Image: View of door entrance.

The second Accessible Entrance is towards the end of George Johnson Lane.



Image: View of George Johnson Lane from Errol St. The laneway passes through an archway with a brick wall at the end.

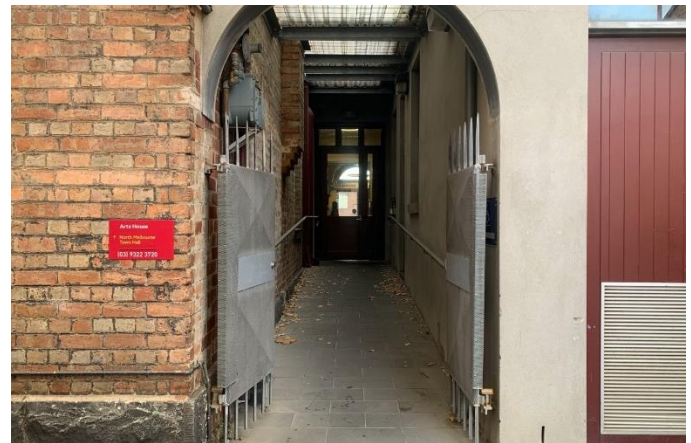
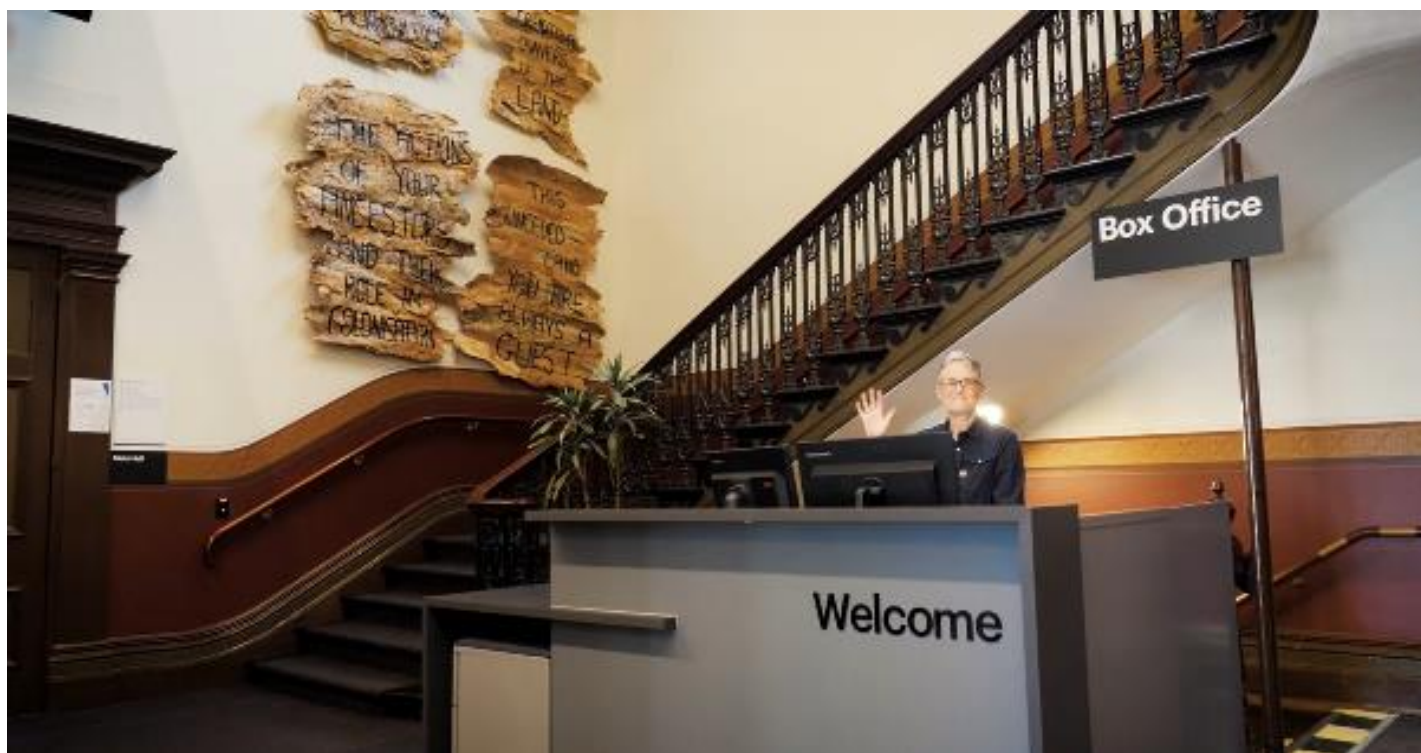

Image: view of the ramp leading from George Johnson Lane to the automated door which opens into the Arts House foyer.

## Reception



The reception is located in the foyer under the stairwell.

## Quiet Space



Arts House Quiet Space is located on Ground Level and is nearby reception and opposite the accessible bathrooms. It includes a range of seating options including soft furnishings, dimmable lights, sensory and stim objects. It is open during venue opening hours and events as a quiet space, prayer or parenting space.





Image: Quiet space with lights dimmed



Image: Quiet space kitchenette and book shelf

## Bathrooms

All bathrooms have Dyson hand dryers with sensor activation. There is an accessible bathroom that is single use on ground level opposite the Quiet Space. There is another accessible bathroom upstairs – this is accessible via lift or stairs.

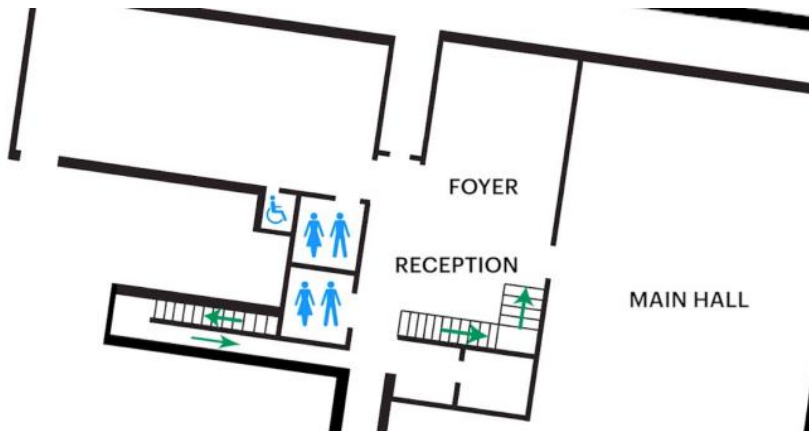

# ARTS HOUSE

## Lift

The lift is located behind reception desk in the foyer.

The closest entry to the lift is via George Johnson Lane.



## Transport

### Tram

Route 57 (High Floor trams only)

Stop 12, North Melbourne Town Hall.

Please note, this is not a wheelchair accessible tram

# **ARTS HOUSE**

## [GETTING TO ARTS HOUSE VIDEO LINK](#)

### **Train**

Arts House is 1.1km from  
North Melbourne Train Station,  
approximately 16 minute walk

[North Melbourne Station Information](#)

1.2km from Flagstaff Station,  
approximately 15 minute walk

[Flagstaff Station Information](#)

### **Bus**

Bus number: 216

### **Parking**

There is limited paid on-street parking on Queensberry Street and Errol Street.

There are two accessible on street car parking spaces on Queensberry Street (150m to our accessible Errol Street entrance) for holders of a Parking Permit for Disabled people.

### **COVID Safety**

Please note: If you have a cough, sore throat, fever, shortness of breath or flu-like symptoms, you must not attend our venue or programs in person.

We will provide a refund if you need to cancel your attendance due to illness. Please contact us by 9am on the day of the event.

To minimise the risk of COVID-19 transmission, we advise all patrons, artists and staff to:

- Practise physical distancing where possible
- Practise good hygiene by washing and or sanitising your hands often

# ARTS HOUSE

- Wear a mask as directed by Victorian Government guidelines

Throughout the venue you will find:

- hand sanitiser stations available
- masks available (ask one of our staff for assistance)
- increased signage to direct patron movement and avoid crowd congestion

We also ensure that spaces are well ventilated.

Staying COVID-safe remains important. We must all follow these steps:

- Follow the Victorian Government's measures on how to stay safe.
- Wear face masks where required or when you cannot safely socially distance.
- Practise COVID-safe hygiene protocols.
- Test for COVID and get free rapid antigen tests at nominated City of Melbourne customer service and library sites.