

HERE WE ARE AMONGST YOU

ARTS HOUSE



Promotional Image for the show

When:

- **Wednesday 29th June:**
7.30pm
- **Thursday 30th June:**
7.30pm
- **Friday 1st July:**
7.30pm
- **Saturday 2nd July:**
7.30pm
- **Wednesday 6th July:**
7.30pm
- **Thursday 7th July:**
7.30pm
- **Friday 8th July:**
7.30pm
- **Saturday 9th July:**
2.00pm
7.30pm - Audio Described Show
- **Sun 10 July:**
5.00pm

All performances will be Auslan Interpreted.

Where:

Arts House

521 Queensberry St

North Melbourne

Duration:

60 minutes

The Venue:

Arts house

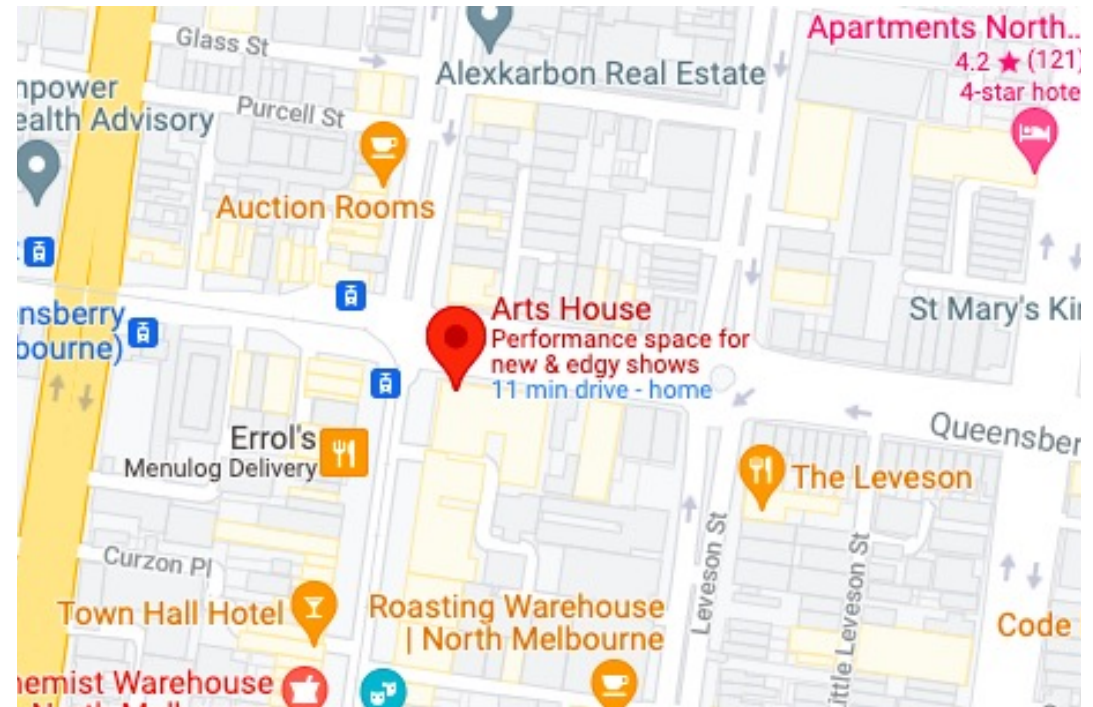

[LINK TO MAP](#)

Front Entrance:



Accessible Entrance:



*The Accessible Entrance is on Errol St next
to the Post Office*

Transport:

Tram:

Route 57

(High Floor trams only)

Stop 12, North Melbourne
Town Hall.

*Please note, this is not a
wheelchair accessible tram*

[GETTING TO ARTS HOUSE VIDEO LINK](#)

Train:

Arts House is 1.1km from
North Melbourne Train
Station, approximately 16
minute walk

or

1.2km from **Flagstaff**
Station, approximately 15
minute walk

[North Melbourne Station Information](#)

[Flagstaff Station Information](#)

Transport:

Bus:

Bus Number: 216

Parking:

There is limited paid on-street parking on Queensberry Street and Errol Street.

There are two accessible on-street car parking spaces on Queensberry Street (150m to our accessible Errol Street entrance) for holders of a Parking Permit for people with Disabilities.

Box Office:



Ushers:



Ushers will be wearing black with an Arts House Logo

Bathrooms:

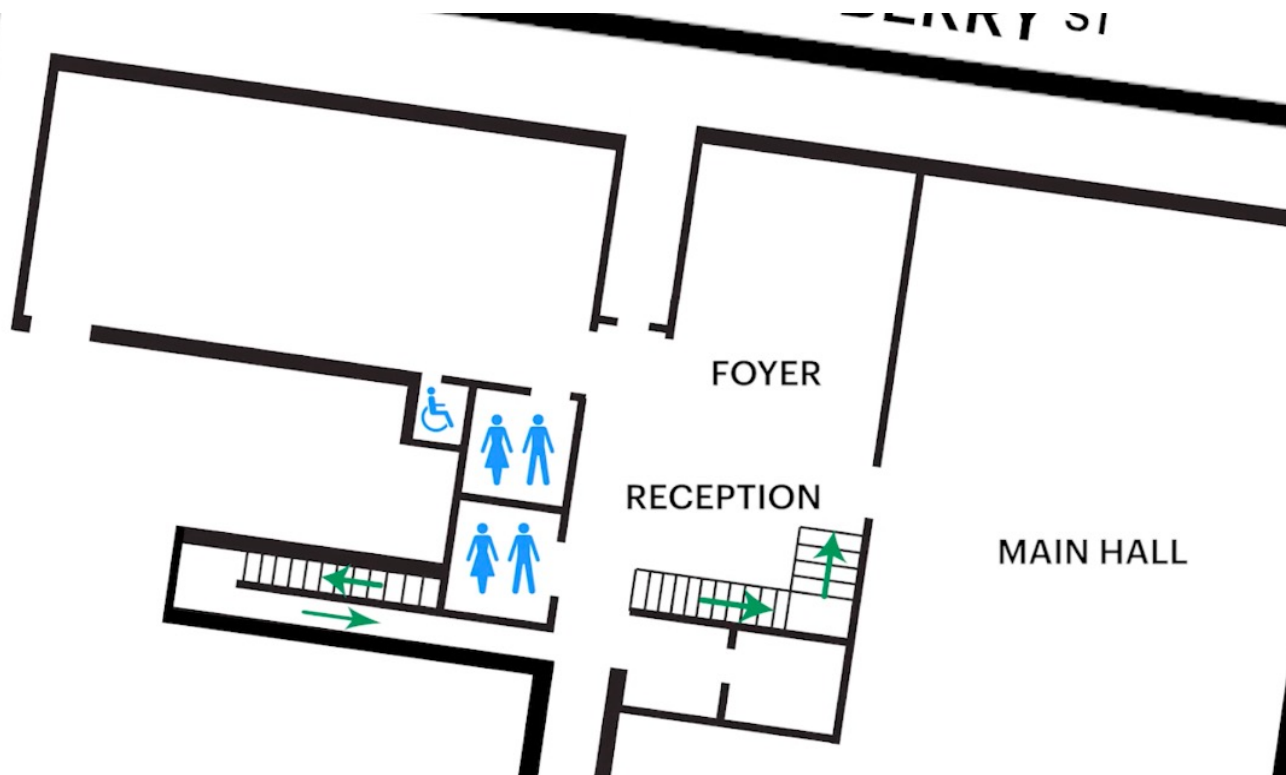

These bathrooms have Dyson hand Dryers

There is an accessible bathroom that is single use on ground level.

There is another accessible bathroom upstairs – this is accessible via lift or stairs.

Door to Main Hall:



- The Performance is in the Main Hall
- *It is on the ground floor*
 - *It is to the left of the box office desk*

Performers:



There are 13 performers in the show

Sensory Notes:

Sound:

- The sound at a times can be loud
- There are deep low frequency sounds - like rumbling
- The sound is transferred into vibration. It can be felt physically
- There are sudden noises

Lighting:

- The lights will change colours and intensity
- The lights will go out for a few seconds at times during the performance
- There are a few moments where the room will get quite dark
- There is **no strobe**. There are flashing lights

Sensory Notes:

Physical:

- The sound is transferred into vibration - it can be felt physically
- Performers will run past you. They will be close to you
- The floor is sprung and may shake as the performers run past

Smell:

- The theatre space is an old space. There may be some old building smell

Visual:

- There is visually busy colourful environment

Sensory Notes:

Shocks or Surprises:

- There are a few lighting, sound and physical shocks
- There is no strobe. There are flashing lights and cheering from the ensemble
- The performers may run past you

Audience:

- The performers may come very close to you during the show
- Sometimes the performers may look directly at you. There is no expectation that you will respond or do anything

Social Expectations:

- There are 13 performers in the show. They will move all around the space including in front and behind the audience.
- You may not be able to see everything that is happening in the show. This is ok.
- There is not a set story to the show. You can make your own meaning from what you experience.
- There is very little dialogue in the show.
- You will watch the show sitting in a circle and you will be able to see the other audience members.
- Sometimes the performers may look directly at you there is no expectation that you will respond or do anything.
- The performers may talk to you. It is ok to either respond or not respond.
- At the end of the show the performers will leave the stage. If you like you can talk to them in the foyer after they leave.

Credits:

Director: Kate Sulan

Designer: Emily Barrie

Composer/Sound Designer: Jethro Woodward

Lighting Designer: Richard Vabre

Co-devisor/Dramaturge: Ingrid Voorendt

Stage Manager: Jess Keepence

Production Manager: Alana Hoggart

Credits:

Rawcus Ensemble:

Clem Baade

Michael Buxton

Harriet Devlin- Dunbar

Rachel Edward

Nilgun Guven

Joshua Lynzaat

Paul Matley

Mike Mc Evoy

Ryan New

Kerryn Poke

Louise Riisik

Prue Stevenson

Danielle von der Borsch